

Wood Rack Assembly Instructions

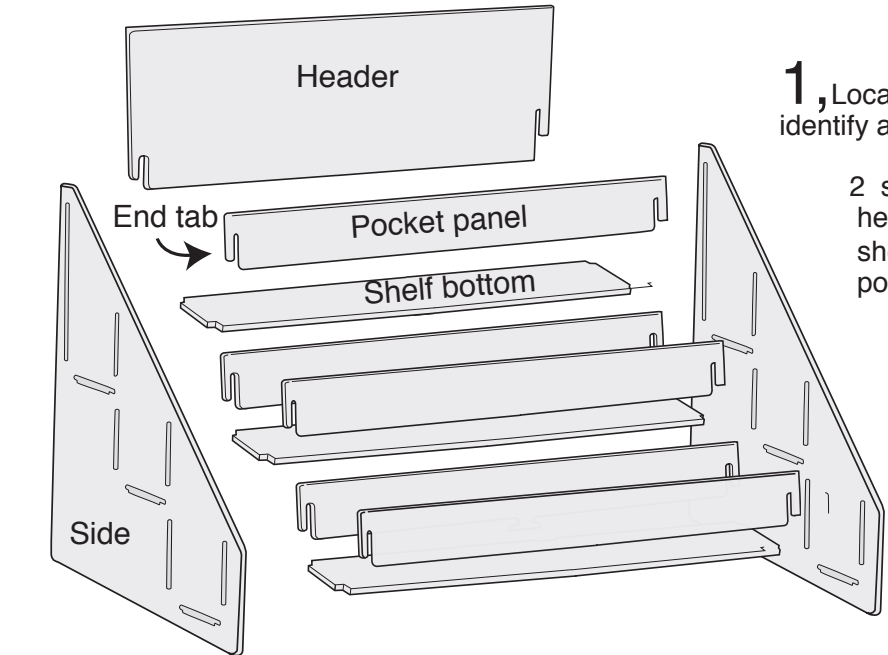

1, Locate and identify all parts.

2 side panels
header panel
shelves
pocket panels

2, Slide a shelf through horizontal slots to join the sides together.

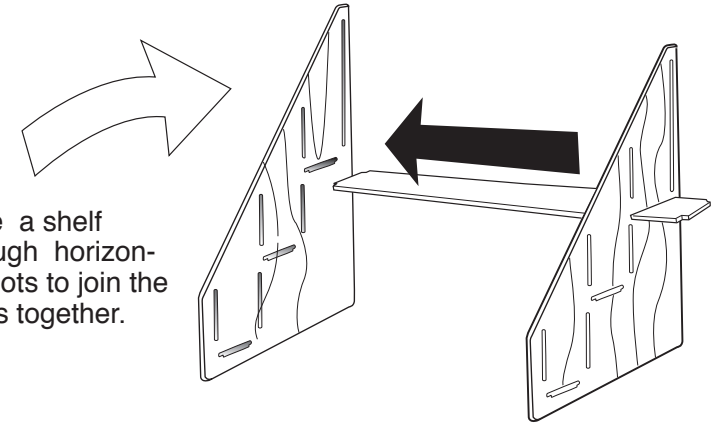

3, Slide header back through the vertical slots as shown

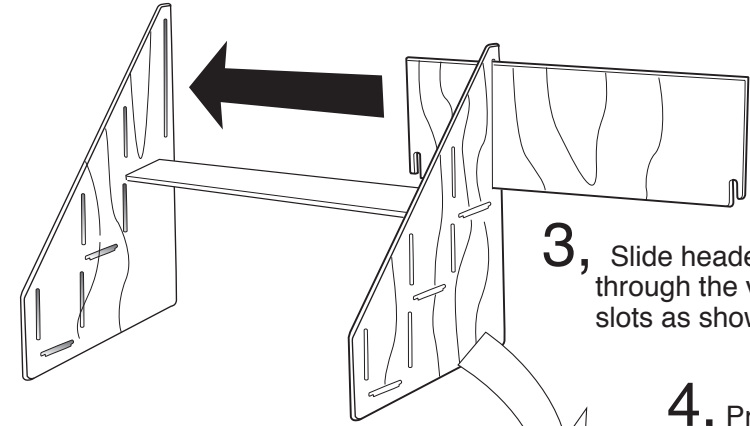

4, Press down header panel to engage end tabs.

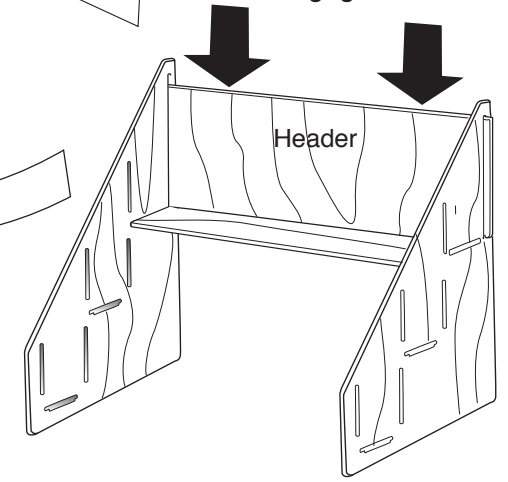

6, Repeat steps 2 through 5 for each shelf, sliding in shelves and pocket panels and engaging end tabs.

5, Slide the pocket panel into the vertical slots. Press down to engage the end tabs.

