

clear solutions Inc.

Assembly Instructions #8907

Tools Needed: flat screwdriver or thin coin (a dime works best)

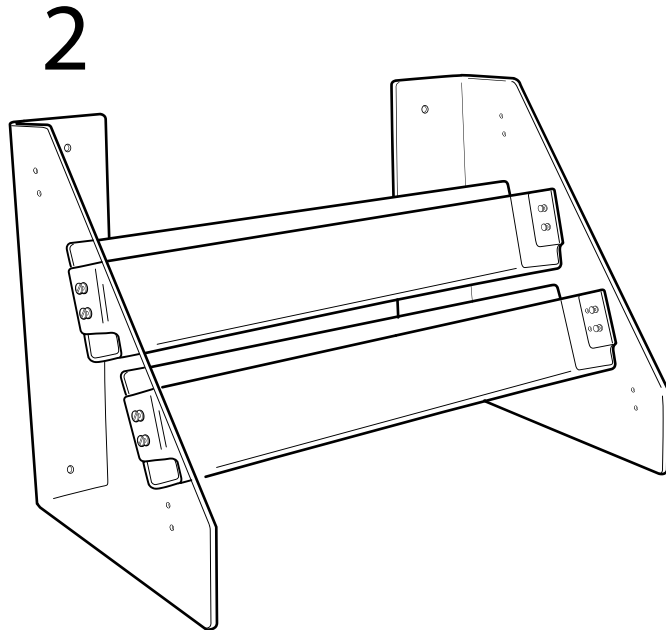
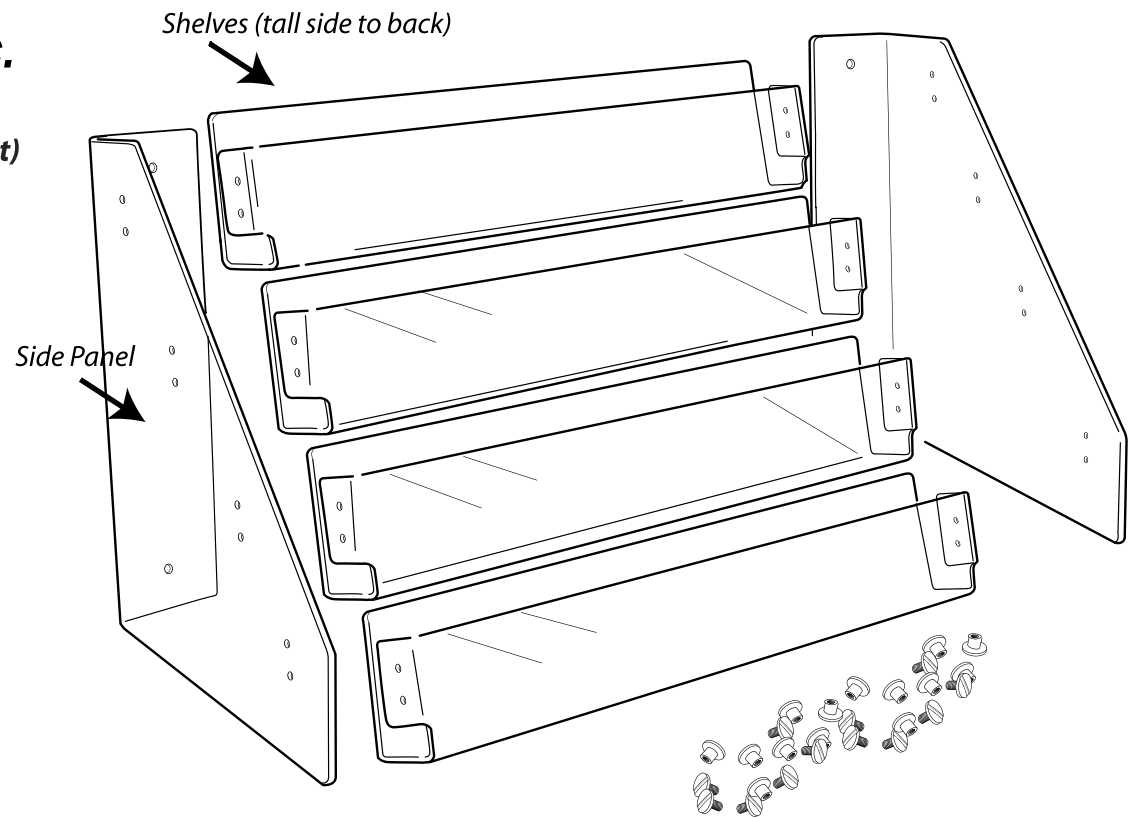
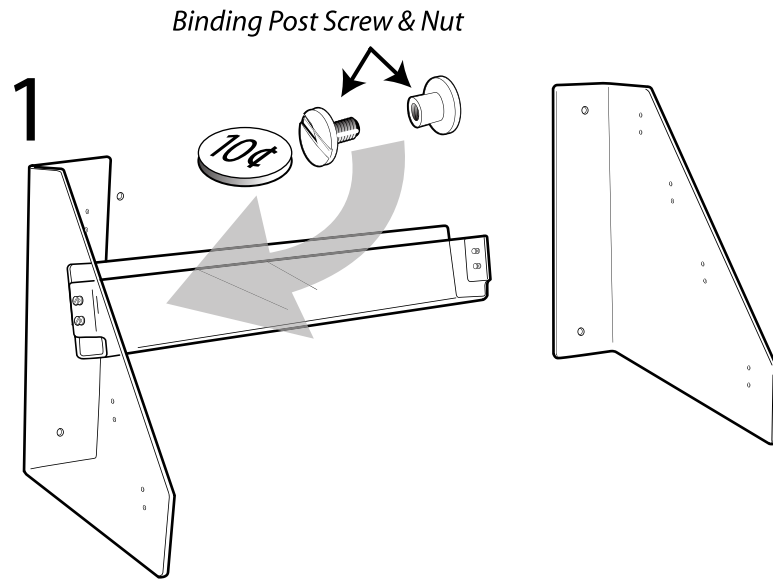

1, Carefully unpack and identify all parts. 2 side panels (a left and a right side), four shelves, and 4 binding post screws and nuts per shelf. Note that the tall side of each shelf faces to the back of the unit.

2, On a clean flat surface, attach the center shelves to each side panel with the binding post screws. If you are attaching the unit to a wall or vertical surface, do it now before attaching top and bottom shelves

3, Attach the other shelves. Once the shelves are attached, check for proper positioning and square and gently tighten all screws.

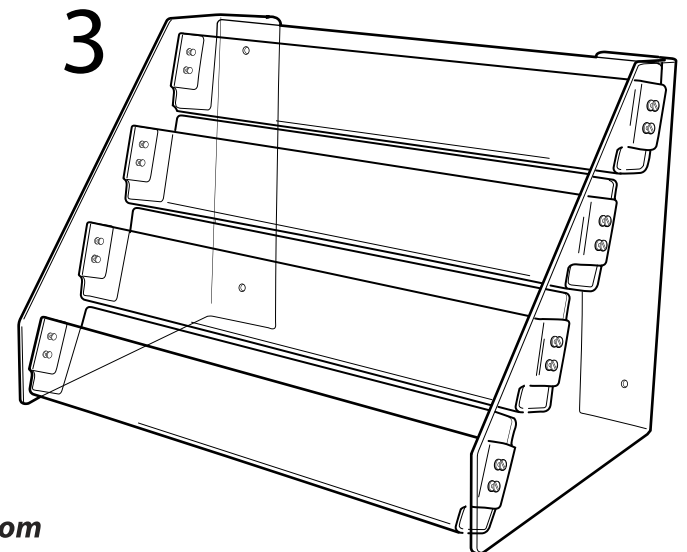

Phone 800-257-4550 E-mail info@cleardisplays.com