

# 3 Tier Slatwall Cascade Assembly

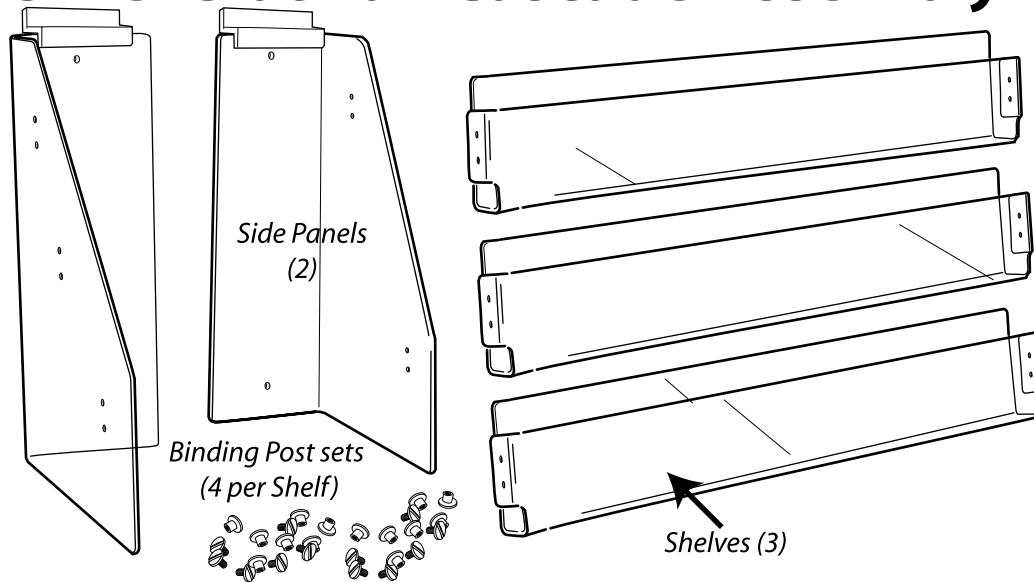

**1,** Locate and Identify all parts:  
3 shelves, 2 side panels, and 12 binding screw and nut sets.

**2,** On a clean flat surface, Install the shelves. Line up the holes of one side panel with the holes in the shelves. Note the tall side of each shelf faces the back of the unit. Loosely attach each shelf to the side panel with the binding screws and nuts provided.

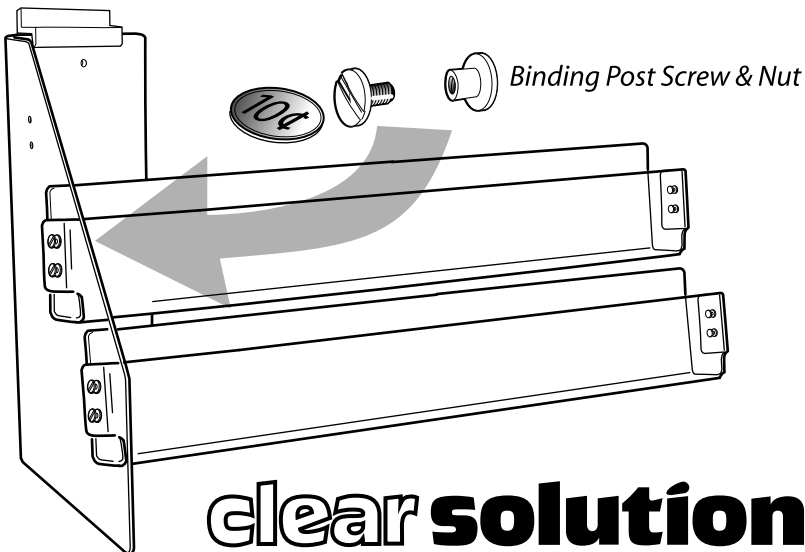

**Tools Needed:** flat screwdriver  
or thin coin (a dime works best)

**3,** Attach the second side panel to each shelf. Turn the shelf unit upright and adjust shelf angles. Check for square before tightening screws until just snug.

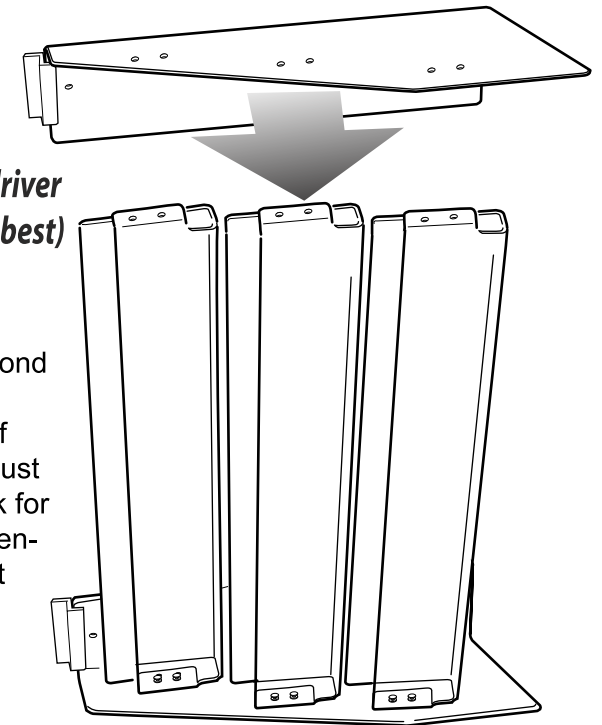

**clear solutions Inc.**

Phone 800-257-4550 E-mail [info@cleardisplays.com](mailto:info@cleardisplays.com) ©Clear Solutions, Inc 9/3/13